

Order from [www.GoKartsUSA.com](http://www.GoKartsUSA.com) or call (925) 938-7360



**(925) 938-7360**

**GokartsUSA**.com

HUGE SELECTION \* QUALITY PRODUCTS \* AFFORDABLE PRICES

WE SHIP WORLDWIDE

GO KARTS MINIBIKES PARTS ACCESSORIES

ORDERS PROCESSED  
WITHIN 2 BUSINESS DAYS

## **KARTCO MODEL 330 & 335 PARTS KIT**



GokartsUSA.com \* Online Order website <http://www.gokartsusa.com> \* (925) 938-7360 voice/fax  
Bulls-Eye Marketing, Inc. P.O. Box 5466, Walnut Creek, California, 94596

**Instructions:**

Use this schematic diagram and parts list below to identify the part numbers you're looking for. Then return to the website for ordering or use the Order Form in this kit.

**Figure 1 Schematic diagram of Kartco models 300 and 335**

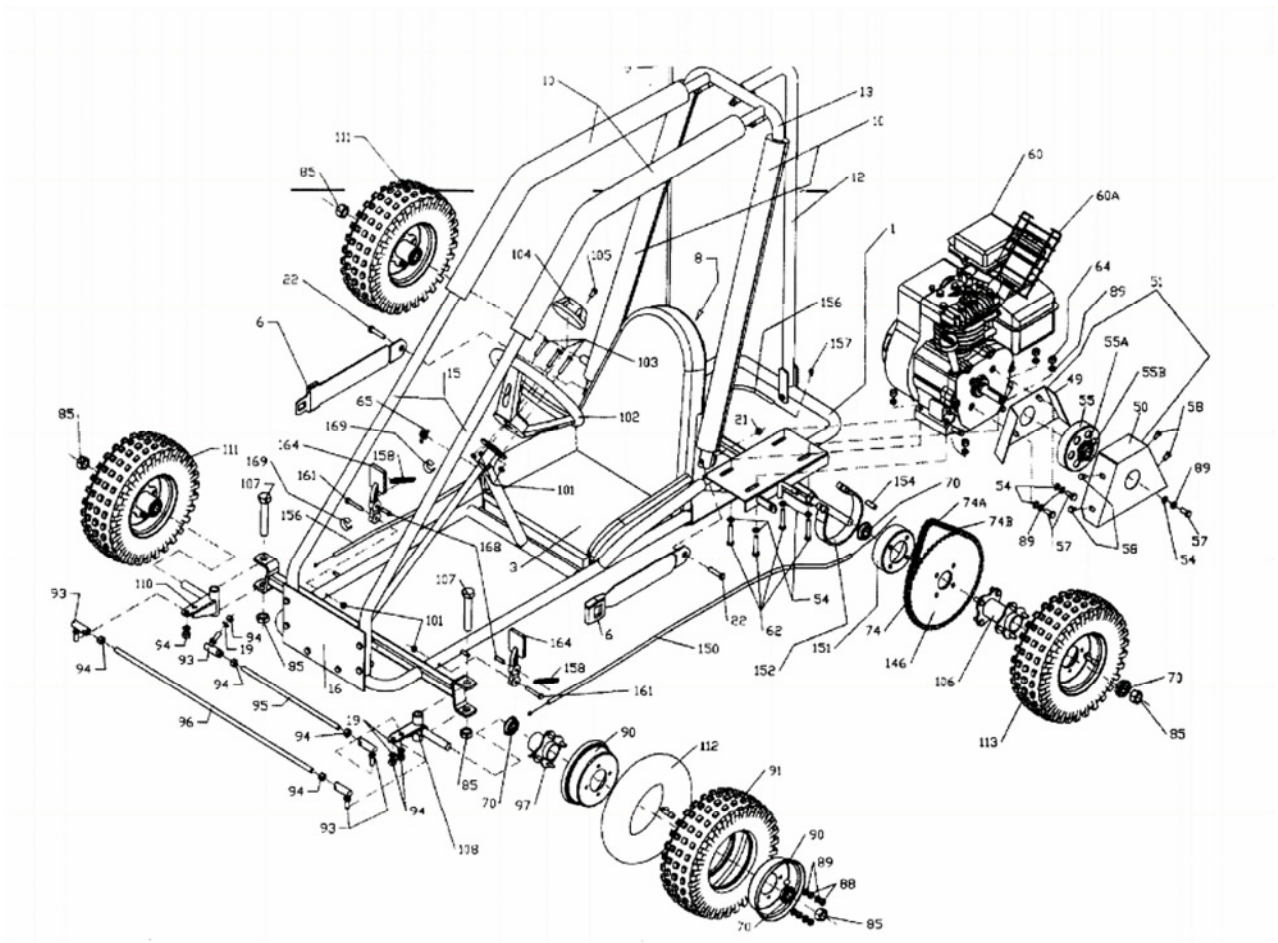

REF. NO.	PART NO.	DESCRIPTION	REF. NO.	PART NO.	DESCRIPTION
1	3101	Frame Assembly, welded parts only	74B	3720	Chain Offset Half Link
3	3801	Seat Cushion, Black	85	9266	5/8" - 18 Jam Lock Nut
6	3440	Lap Belt, 26" Blue	88	9223	5/16" - 24 Hex Nut
8	3428	Bracket, Safety flag	89	9330	5/16" Split Lock Washer
9	3431	Safety Flag (models 330, 335, 335T)	90	3623	5" Front and Rear Dishes
	3432	Safety Flag (models 300LX, 350LX, 350LXT)	91	3605	5" Tire
	3429	Safety Flag (models 303, 305)	93	3306	Ball Joint 3/8"
10	4901	10A - KKT - 3 foam rubber kit	94	9235	3/8" - 24 Hex Nut
12	3358	Rear Bar Motor cage	95	3305	Steering Rod (3/8" x 11-1/2")
13	3357	Front Bar Motor cage	96	3304	Steering Rod (3/8" x 24-3/16")
15	3355	Bar, O/H cage	97	3215	Wheel Hub
18	4717	Front Plate, O/H cage	101	9256	1/4" - 20C/L Nut
19	9345	3/8" lock washer	102	3309	Steering Wheel
21	9234	5/16" Nylon Locknut, NC	103	9108	Steering Wheel Bolt, 1/4" - 20 x 1 1/2" GR 5 Bolt
22	9113	5/16" x 1 1/2" NC5 Bolt	104	3310	Cap, Steering Wheel
49	3351	Chain Guard Bracket	105	9099	Cap Screw
50	3353	Chain Guard Cover	106	3214	Drive Wheel Hub
51	3354	Chain Guard Kit	107	9037	5/8" - 18 x 3 1/2" GR 5 Bolt
52	9115	5/16" x 2" NF Bolt	108	3316	Spindle Assembly, Left Hand Side
54	9340	5/16" flat washer	110	3315	Spindle Assembly, Right Hand side
55	3706	Clutch Assembly, 3/4" Bore, 10 tooth	111	3204	5" Front Wheel Assembly
55A	3707	Max-Torque Clutch sprocket and Bushing	112	3605	5" Inner Tube
55B	3704	Max-Torque Clutch Bushing	113	3213	5" Drive Wheel Assembly w/Hub
57	9104	1/4" - 24 x 3/4" Bolt (Models 300LX, 303, 330)	146	3511	Sprocket
	9463	5/16" - 24 X 3/4" bolt (Model 305, 335, 335t, 350b, 350bt)	150	3411	Brake Cable
58	9118	1/4" - 20 x 1/2" Self Tap Screw	151	3502	Brake Drum
60	3550	3.5 HP B & S Engine (Models 300LX, 303, 330)	152	3501	Brake Band
	4554	5HP B & S engine (Models 305, 335, 350LX)	154	3413	Brake Band Pin
	4550	5HP Tecumseh Engine (Models 335T, 350LXT)	166	3407	Throttle Cable
60A	4554-A	Muffler Guard (Models 305, 335, 350LX)	157	3415	Swivel Assy. Clamp
62	9114	5/16" - 18 x 1 3/4" GR 5 Bolt	158	3409	Pedal Return Spring
64	9233	5/16" NC Hex Nut	161	9103	1/4" 20 x 1 3/4" GR 5 Bolt
65	3420	Kill Switch Kit	164	3401	Pedal
70	3602	5/8" Bearing	168	9432	1/4" x 7/8" Clevis Pin
74	3718	Chain #41	169	3404	Cable Clip
74A	3719	Chain Connector Link (Master Link)			



# GoKartsUSA.com

**Bulls-Eye Marketing, Inc.**  
 P.O. Box 5466  
 Walnut Creek, California 94596  
 925.938.7360 Fax 925.938.7360

# PURCHASE ORDER

**P.O. NUMBER:**

**Bill To: (credi card holder)**

Name  
 Address  
 City  
 State, Zip  
 Country  
 Telephone  
 Credit Card #  
 Expiration mmyy

**Ship To:**

Name  
 Address  
 City  
 State, Zip  
 Country  
 Telephone  
 Email Address

P.O. DATE	REQUISITIONER	SHIP VIA	F.O.B. POINT	TERMS

QTY	PRODUCT#	DESCRIPTION	UNIT PRICE	TOTAL

SUBTOTAL

California residents ad 8.25% SALES TAX

SHIPPING & HANDLING

TOTAL

Authorized by \_\_\_\_\_

Date \_\_\_\_\_

## Ordering Replacement Parts

Submit Secure Online Parts Orders 24 Hours A Day Online

Our parts are currently being loaded for Online Ordering. If you do not [see the parts](#) You want available for Online Ordering, please use the following procedure for ordering parts:

1. Click Here for to download the [complete Parts Catalog](#).
2. Click here for [Mail In Order Form](#).
3. Complete the Order Form and fax to (925) 938-7360

Most of the parts featured in our online catalog require that particular measurements be noted prior to placing a parts order. Please keep this in mind while making your selections. It is in everyone's best interest to keep parts exchanges to a minimum. If you require assistance selecting parts, be prepared to tell us about your machine. Brand name, model number and/or name, drive system features, tire size, chain size used, etc..

If you submit an online parts order and discover that you have made a mistake or if you would like to add additional parts to your order please contact us as soon as possible so that we can make the necessary adjustments.

UPS Shipping Services offered: UPS Next Day Air®, UPS 2nd Day Air®, 3 Day Select and UPS Ground. We do not ship C.O.D. orders. UPS will not deliver to Post Office Box addresses.

### **All prices & specifications in our web site are subject to change without notice**

From time to time, manufacturers or suppliers either raise prices or upgrade the products, and these changes may not be shown on the website immediately. This is why the products may differ slightly from what is shown. However all changes are usually to improve or update the product, and does not lower the quality of the merchandise.

Parts ordered from this website should be installed and used by persons that are familiar with mechanical parts and their proper use and installation. Consult the manufacturer of the parts for its proper use and mechanical requirements. Customer assumes responsibility for maintaining products and/or equipment in safe operating condition. These vehicles are not designed or manufactured or sold for use on public streets, roads, highways, or right of ways. Read the owners manual before operating. Wear an approved helmet, clothing & eye protection when riding. Parental supervision is advised.

Not designed or intended for rental track use.

#### **HOW TO ORDER**

**PLACE AN ORDER THROUGH OUR WEBSITE:** *This is the preferred and best way to place your order.* Follow the steps in the shopping cart. Fill out the order form completely making sure that all spaces that apply are filled in and correct to make sure that you receive your order without delay.

**TO PLACE A TELEPHONE ORDER:** Call our phone order line at (925) 938-7360 Monday through Thursday between 9:30am and 4:00pm PST. Use your Visa, MasterCard, American Express or Discover Credit Cards.

**MAIL IN ORDERS:** Print and complete the Order Form on this website and mail to to GokartsUSA, P.O. Box 5466, Walnut Creek, CA 94596. Use your Visa, MasterCard American Express or Discover card, or enclose a personal check, company check, certified check, or money order. We do not ship C.O.D. California Residents add 8.25% Sales Tax.

**TO PLACE AN ORDER BY FAX:** Print and complete the Order Form on this website and fax to (925) 938-7360. Use your Visa, MasterCard American Express or Discover card. On fax orders using a credit card, the credit card owner must sign where indicated on the order form. California Residents add 8.25% Sales Tax.

#### **PAYMENT METHODS FOR ORDERS**

**CREDIT CARD ORDERING: WE SECURITY CHECK ALL CREDIT CARDS.** We accept Visa, MasterCard American Express and Discover credit cards. When placing orders, you must have the credit card with you because we need the following information from the credit card: We need the expiration date, the credit card number, the cardholder's phone number for the home & where they can be reached during the day, the credit card owner's name and billing address. On mail-in orders, the credit card owner must sign where indicated on the order form.

**PERSONAL OR COMPANY CHECKS:** GoKartsUSA reserves the right to hold all personal & company checks until they clear the bank. Orders with certified bank checks, or money orders will be processed sooner.

**C. O. D. SHIPMENTS:** We do not ship C.O.D.

**GO KARTS & MINIBIKES SHIPPING INFORMATION MOST GOKARTS AND MINIBIKES ARE SHIPPED FREE!!**

**DELIVERY TIME FOR GO KARTS & MINIBIKES IS APPROXIMATELY TWO WEEKS.**

- **some GO KARTS** are shipped by truck lines. They are too large & too heavy to go by UPS.
- **GO KART KITS** are shipped by UPS.
- **some MINIBIKES** are shipped by truck lines. They are too large & too heavy to go by UPS.
- **MINIBIKE KITS** are shipped by UPS.

**TRUCK LINE SHIPMENTS** Will be shipped to your home or your business free. Additional Truck shipping charges may apply as determined by the weight of the Go Kart or minibike and the distance the truck line has to go to deliver it, and whether it is going to a business or residence. Non-direct shipment charges are higher. We will contact you if any additional shipping charges apply prior to shipping your order.

Truck companies do not require their drivers to unload shipments. Truck drivers will get the merchandise to the back of the truck. You are required to unload it. Go Karts & minibikes can be slid down the back of the truck without lifting them, don't do this by yourself. On heavy merchandise prepare to have someone help you unload it. Lift gate service is not included in the shipping charge. If you need lift gate service you will have to pay extra for it. Indicate this at checkout time.

- **ALL GO KARTS & MINIBIKES MUST BE PREPAID BEFORE THEY ARE SHIPPED. On vehicles that do not have free shipping, SHIPPING CHARGES must also be prepaid. UPS SHIPPING CHARGES** For Go Kart and Minibike kits are also based on

the weight of the vehicle and the distance that UPS has to travel to deliver it. **ALL GO KARTS & MINIBIKES ARE SHIPPED FROM THE FACTORY TO YOU. THIS SAVES YOU MONEY ON SHIPPING AND GETS THE GO KART OR MINIBIKE TO YOU FASTER.**

- **SHIPPING CHARGES ON ORDERS OUTSIDE OF THE CONTINENTAL LIMITS OF THE UNITED STATES MUST BE PREPAID IN U.S. FUNDS. CALL FOR SHIPPING CHARGES.**

**WARNING:** Go Karts, Minibikes, and parts are machinery. They must be maintained and treated accordingly, and can be dangerous. They have moving mechanical parts. You should not have loose clothing, long hair, hands, or other parts of your body around moving parts. Read all manufacturers safety precautions that come with the vehicles.

**SHIPPING POINTS: GO KARTS & MINIBIKES ARE SHIPPED FACTORY DIRECT.** Parts are shipped separate from the Go Karts & minibikes.

### **ENGINES, PARTS, ACCESSORIES SHIPPING INFORMATION**

**DELIVERY TIME FOR ENGINES, PARTS and ACCESSORIES IS APPROXIMATELY 7 TO 10 WORKING DAYS.**

Shipping charges are shown on the order form. You must include shipping charges on all engine, parts, and accessory orders. You can leave it blank and we will confirm the shipping charge with you prior to shipping.

**ENGINE SHIPPING CHARGES:** When you order an engine the shipping charge is in addition to other items ordered.

**HANDLING CHARGE:** A Handling/Package Charge may be applied to ALL orders. This Charge is to cover packaging supplies such as the crate, shipping palette, box, tape, labels, etc. which are necessary to pack and ship the order.

**BACK ORDERS:** If we are out of the part or parts that you ordered we will back order the part. Back orders are noted on your invoice. If an item is on back order for more than 7 to 10 days, we will notify you by e-mail. If the part is not available we will issue you a full refund on the parts not shipped. In some cases you may be charged an additional shipping charge for the back order shipment.

**WARRANTY:** ALL ITEMS IN OUR CATALOG AND ON OUR WEBSITE THAT COME WITH A WARRANTY are warranted by the manufacturer, NOT GOKARTSUSA. All warranty procedures that the manufacturer requires must be followed, no exceptions. Any part or accessory that is covered by a warranty MUST be returned to the manufacturer for inspection BEFORE a refund, credit or exchange can be issued. Go karts, Minibikes, Engines, and large items do not have to be returned, but MUST be inspected by an authorized dealer in your area BEFORE a refund, credit or exchange can be issued. Contact GoKartsUSA for details and further instructions if you think you have a warranty situation BEFORE you do anything. Warranty claims on Briggs & Stratton, Tecumseh & Honda engines that come with and are a part of the go karts & minibikes that we sell are warranted by the manufacturer & can be handled by their authorized dealer in your area. A warranty comes with each vehicle that spells out the warranty and time periods. If you have any questions call GoKartsUSA and we will help with the warranty.

BRIGGS & STRATTON & TECUMSEH ENGINES That are sold by themselves, not attached to other merchandise are warranted by the manufacturer The warranty can be handled by your nearest Briggs or Tecumseh authorized dealer. RACING ENGINES ARE SOLD WITHOUT A WARRANTY.

When you buy from GoKartsUSA you are buying quality merchandise.

**SHIPMENTS OUTSIDE OF THE U.S. MUST BE PREPAID IN U.S. FUNDS ONLY. WE WILL**



**QUOTE SHIPPING CHARGES TO SHIP YOUR ORDER TO A U.S. PORT, AND IT IS THE CUSTOMER'S RESPONSIBILITY TO ARRANGE SHIPPING FROM THE U.S. PORT TO THE FOREIGN DESTINATION. E-MAIL FOR FURTHER SHIPPING INFORMATION.**

### **RETURNS**

**PARTS AND ACCESSORIES:** All returns must be made within 30 days of the invoice date. **NO EXCEPTIONS.** Call or write our customer service department for an authorization number to return merchandise. **NO RETURNS ACCEPTED** Unless this number is on the outside of the package on your return label. We will give full credit on faulty merchandise or our errors. All other returns are subject to a 20% restock fee. Customer is responsible for all shipping charges, including shipping charges on parts that the customer orders incorrectly. You must return a copy of your invoice with your return, a letter explaining the reason for the return and any exchanging of items you want to make. Under normal conditions You will be issued a credit within 3 weeks from the date we receive the return.

NO RETURNS will be accepted on used, damaged, altered OR SPECIAL ORDERED merchandise. damaged, used or altered merchandise returned to GoKartsUSA will be returned to you at your expense or discarded & no credit will be issued.

GO KARTS, MINIBIKES, ATVs & other merchandise: Cannot be returned once they are assembled , used, damaged, or altered. The customer is responsible for all shipping, handling, and restock fees on all Go Karts and Minibikes cancelled or returned after they are shipped.

**SHIPPING DAMAGE:** When you receive your order and there is noticeable damage to the carton or merchandise, Please tell the delivering carrier and have them note this on their freight bill. This will protect you if you have to make a claim. ALL DAMAGE CLAIMS MUST BE HANDLED BY YOU DIRECTLY WITH THE DELIVERING CARRIER. They are responsible for shipping damage, not GoKartsUSA. We will assist you with a damage claim.

### **CATALOG & WEBSITE ERRORS**

**WE RESERVE THE RIGHT TO CORRECT CATALOG & WEBSITE ERRORS.**

**PRICING POLICY:** Prices and specifications in the catalog and on this website are subject to change without notice and supersede previous catalog & website prices and specifications. If there is a small price increase, we will adjust your order accordingly. On major changes, we will contact you before your order is shipped to inform you of the changes.

**CUSTOMER SERVICE:** Call or FAX to (925) 938-7360 or Email: [Sales@GoKartsUSA.com](mailto:Sales@GoKartsUSA.com) or write to: GoKartsUSA, P.O. Box 5466, Walnut Creek, CA 94596

**By ordering from GoKartsUSA, you are agreeing to these ordering terms and conditions.**



Order from [www.GoKartsUSA.com](http://www.GoKartsUSA.com) or call (925) 938-7360

Thank you for ordering from GokartsUSA...Happy riding